

REV.	DESCRIPTION	DRAWN	CHECKED	APPROVED
A	NEW RELEASE	ZQJ 11/18/2014	~	ZQJ 11/18/2014
B		CJJ 11/18/2014	~	ZQJ 11/18/2014
C		CJJ 11/18/2014	~	

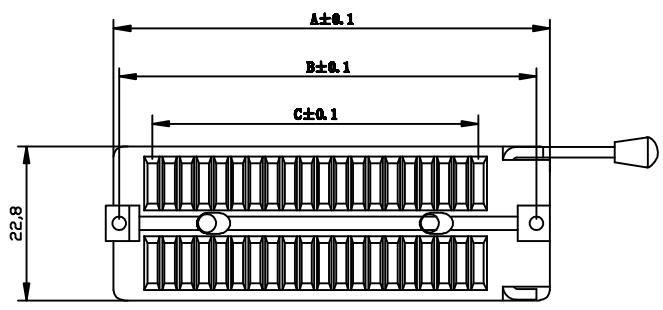
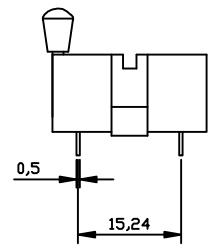
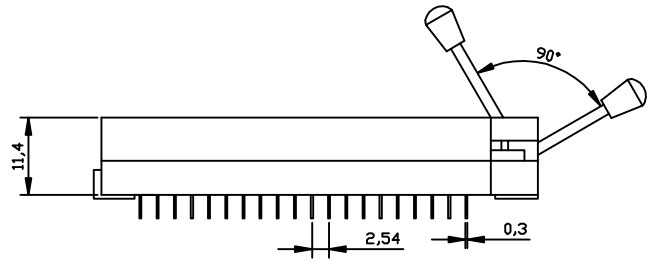

Material:  
Housing: 30% Glass filled PBT UL94-0.  
Contacts: Phosphor Bronze.  
Plating: Gold plated: 3u" over 50u" nickl.  
Tin plated: 100u" over 50u" nickl.

Electrical Characteristics:  
Current Rating: 1 AMP.  
Insulator Resistance: 5000M $\Omega$  min, at DC 500V  
Contact Resistance: 20m $\Omega$  max, at DC 100mA  
Operating Temperature: -55 $^{\circ}$ —+105 $^{\circ}$ .

Position	A	B	C
24P	44.1	40.8	27.94
28P	49.3	46.5	33.02
32P	54.4	50.4	38.1
40P	64.6	60.6	48.26
48P	74.6	70.6	58.42

Features:  
For DIPs with .100" lead spacing  
Lever actuated zero insertion force mechanism  
Socket easily disassembles for repairability.  
Socket contact point of .110" below top surface of socket.

GENERAL TOLERANCE		ANGLE TOLERANCE		PROJECTION	TITLE	2.54MM ZIF SOCKET ROUND PIN	
X.	±0.60	X.	±5°	UNITS	mm		
.X	±0.38	.X	±3°	SHEET SIZE	A4	SERIES	LL1002-2
.XX	±0.25	.XX	±2°	慈溪蓝翎电子有限公司 CIXI LANLING ELECTRONICS CO., LTD. Tel: 86-574-63519036 Fax: 86-574-63517070			
DRAWING TYPE		CUSTOMER					
SCALE	1:1	SHEET	1 OF 1				
DRAWING NO.							