

REV.	DESCRIPTION	DRAWN	CHECKED	APPROVED
A	NEW RELEASE	ZQJ 11/18/2015	~	ZQJ 11/18/2015
B	ADD P/N CODE	CJJ 11/18/2015	~	CJJ 11/18/2015

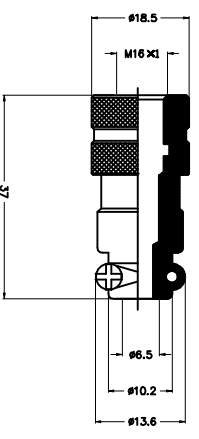
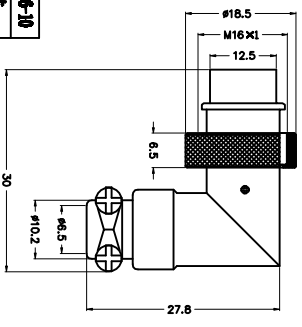
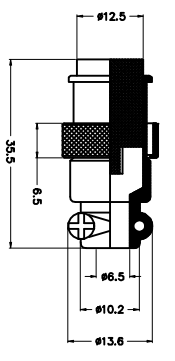
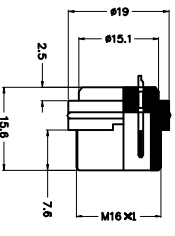
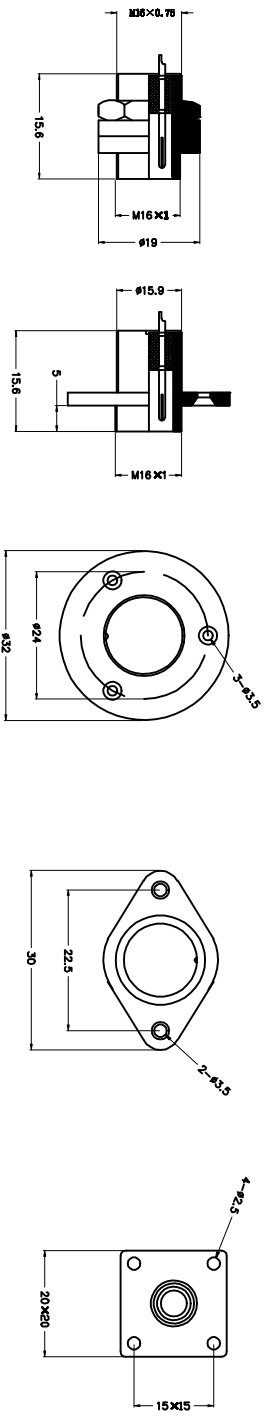

系列代号 Small code	YL1-16-2	YL1-16-3	YL1-16-4	YL1-16-5	YL1-16-6	YL1-16-7	YL1-16-8	YL1-16-9	YL1-16-10
接触型式 Contact arrangement on which contacting pins and the contacts are soldered	正常 Normal	正常 Normal	正常 Normal	正常 Normal	正常 Normal	正常 Normal	正常 Normal	正常 Normal	正常 Normal
插孔间距/间距 Pitch Pitch	7L-1557	7L-1557	5L-1557	5L-1557	4L-1557	4L-1557	4L-1557	4L-1557	4L-1557
工作电压 (AC) 99V Operating Voltage (AC) 99V	200	200	200	200	200	200	200	200	200
额定电压 (AC) 155V Rated Voltage (AC) 155V	1500	1500	1500	1500	1500	1500	1500	1500	1500
额定电流 (DC) 100mA Rated Current (DC) 100mA	1500	1500	1500	1500	1500	1500	1500	1500	1500
额定功率 (DC) 10W Rated Power (DC) 10W	10	10	10	10	10	10	10	10	10
插孔间距 (mm) Pitch (mm)	2.45	2.45	2.45	2.45	2	1.15	1.15	1.15	1.15

YL1-16 系列 2T-10T

GENERAL TOLERANCE		ANGLE TOLERANCE	
X.	±0.60	X.	±5°
.X	±0.38	.X	±3°
.XX	±0.25	.XX	±2°

2	CONTACT	DRAWING TYPE	CUSTOMER	SCALE	1:1	SHEET	1 OF 1
1	HOUSING	DRAWING NO.					
1	PART NAME						

PROJECTION UNITS: mm

TITLE: Micro Jack Connector

SHEET SIZE: A4

SERIES: YL1-16

慈溪蓝翎电子有限公司
CIXI LANLING ELECTRONICS CO., LTD.