

REV	DESCRIPTION	DRAWN	CHECKED	APPROVED
A	NEW RELEASE	ZGJ 11/18/2014		
B	ADD P/W CODE	CJJ 11/18/2014		

R/A TYPE

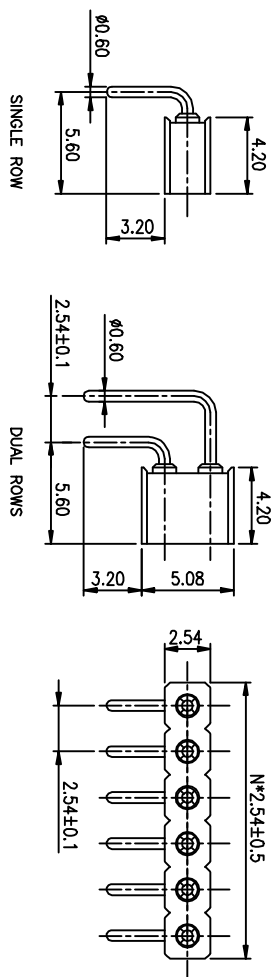

SMT TYPE

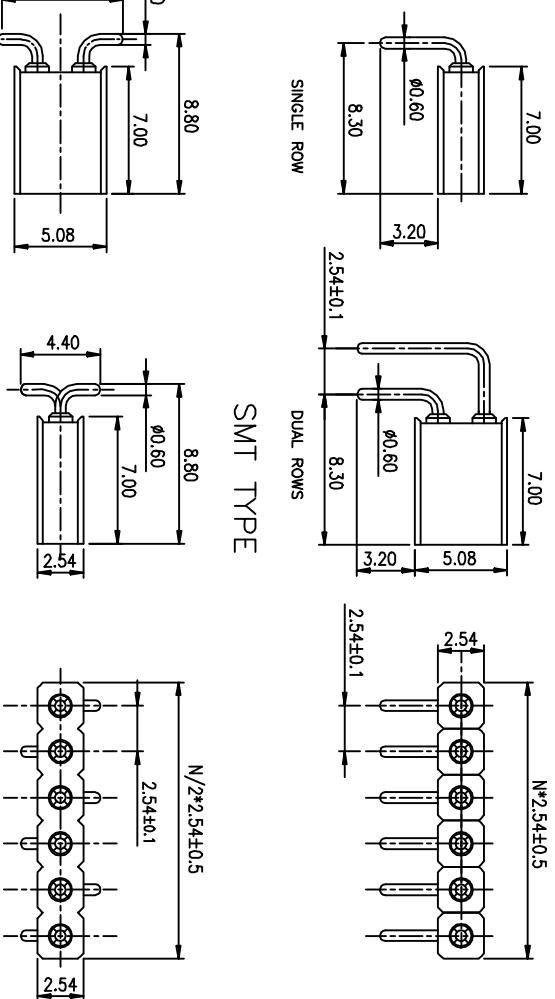

NOTES:

- ELECTRICAL:
 - 1.1 Current rating: 3amps/contact max.
 - 1.2 Contact resistance: $\leq 20m\Omega$ /contact.
 - 1.3 Insulation resistance: $\geq 1000M\Omega$ at $V=100V$.
 - 1.4 Operating voltage: 60V AC/DC.

2. PRODUCT NUMBER CODE:

LL1019-7 - X X X X X X

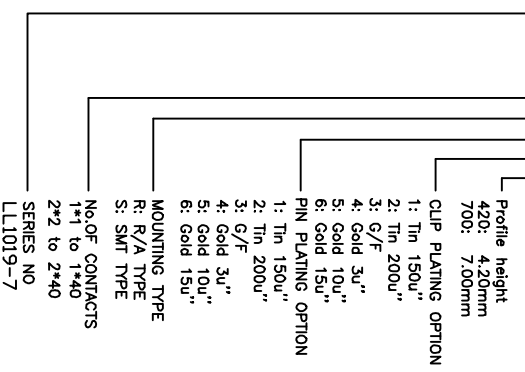

GENERAL TOLERANCE	ANGLE TOLERANCE	PROJECTION	TITLE
X, ±0.60	X, ±5°	UNITS	SMT & R/A IC SOCKET PITCH 2.54mm
.X, ±0.38	X, ±3°	SHEET SIZE	MATING PIN $\phi 0.47$ H=7mm/4.2mm
.XX, ±0.25	.XX, ±2°	A4	LL1019-7
DRAWING TYPE	CUSTOMER	SERIES	
SCALE	1:1	SHEET	
DRAWING NO.			

慈溪蓝翎电子有限公司
CIXI LANLING ELECTRONICS CO., LTD.