

REV	DESCRIPTION	DRAWN	CHECKED	APPROVED
A	NEW RELEASE	ZQJ 11/18/2014	~	ZQJ 11/18/2014
B	ADD P/N CODE	CJJ 11/18/2014	~	

N:NUMBER OF CONTACTS

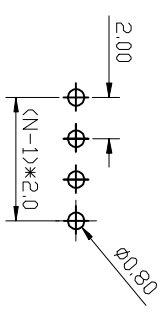
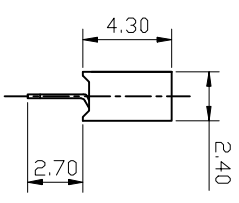
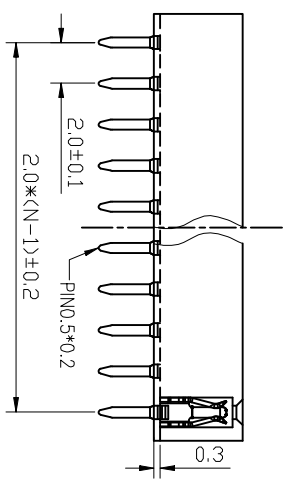
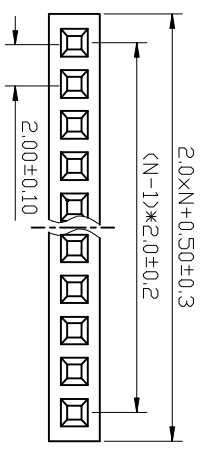

RECOMMEND PCB LAYOUT  
(TOLERANCE=±0.05)

NOTES:

- ELECTRICAL CHARACTERISTICS:
  - CONTACT RESISTANCE: 20mΩ Max. INITIAL.
  - DIELECTRIC WITHSTANDING VOLTAGE: 500V AC(rms) FOR 1 MINUTE.
  - INSULATION RESISTANCE: 1000MΩ Min.
- ENVIRONMENT CHARACTERISTICS:
  - TEMPERATURE: -40°C~+105°C.

GENERAL TOLERANCE	ANGLE TOLERANCE
X, ±0.60	X, ±5°
.X, ±0.38	.X, ±3°
.XX, ±0.25	.XX, ±2°

DRAWING TYPE	CUSTOMER	SCALE	SHEET	1 OF 1
.XX		1:1		

PROJECTION	TITLE
mm	FEMALE HEADER PITCH 2.0mm

UNITS	SHEET SIZE	A4	SERIES	LL1017-1

慈溪蓝翎电子有限公司  
CIXI LANLING ELECTRONICS CO., LTD.

